



## Chowns Hill, Hastings TN35 4PA

Offers in excess of £250,000



Spacious three bedroom, ground floor apartment with STUNNING COUNTRYSIDE VIEWS, garage and off road parking. Forming part of this CHARACTERFUL RESIDENCE and set in a semi rural location, elevated above the town, you have a beautiful outlook making this a PEACEFUL AND TRANQUIL HOME. Accessed via a PRIVATE FRONT DOOR there is an ENTRANCE PORCH, leading to the living room which measures 16'5 x 11'1 featuring a large window framing the rear views, with ample room for a full dining table. The SEPARATE MODERN FITTED KITCHEN offers ample storage and worktop space, providing room for appliances. There are THREE BEDROOMS which are generous double rooms with one of the bedrooms enjoying BUILT-IN STORAGE, together with the FAMILY BATHROOM, which has been beautifully tiled and houses a bath with shower over. To the front of the property there are park-like communal gardens, RESIDENTS PARKING and access to the PRIVATE GARAGE. Being sold with a SHARE OF FREEHOLD, this property would make the perfect FIRST TIME OR FAMILY HOME.

# Merivale

Approximate Gross Internal Floor Area  
869 sq. ft / 80.73 sq. m

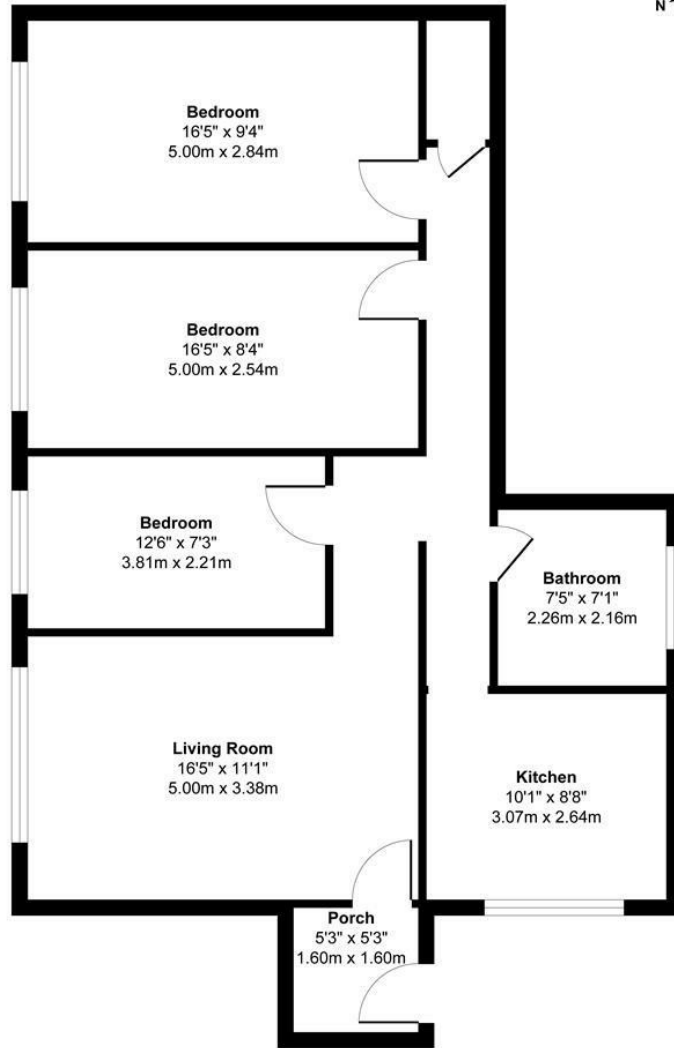

GROUND FLOOR

